

LOC		DIST		REVISIONS				
P	LTR	DESCRIPTION	DATE	DMN	APVD			
A1		REVISED PER ECO-08-009053	16APR08	DH	AS			
A2		REVISED PER ECO-10-000444	16JAN10	KK	AEG			

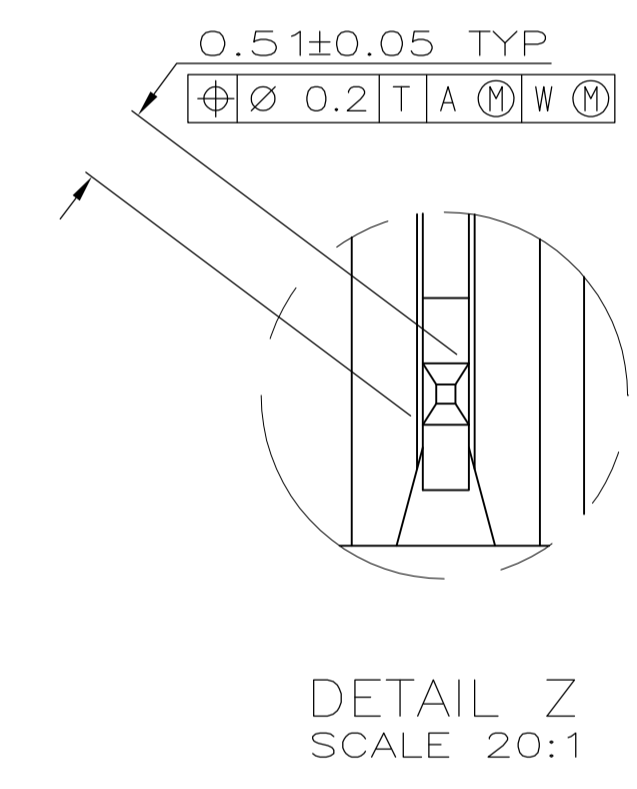
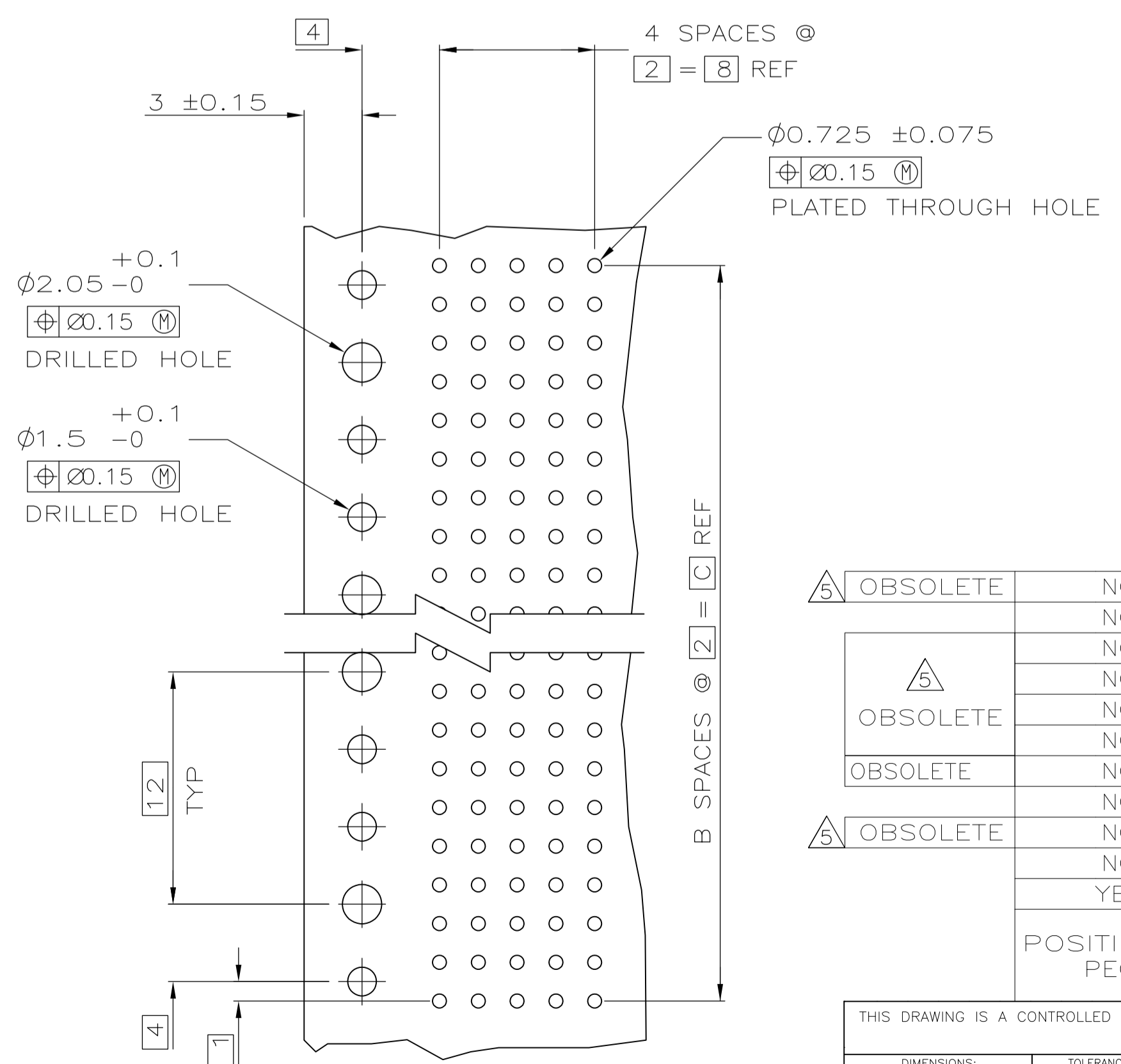
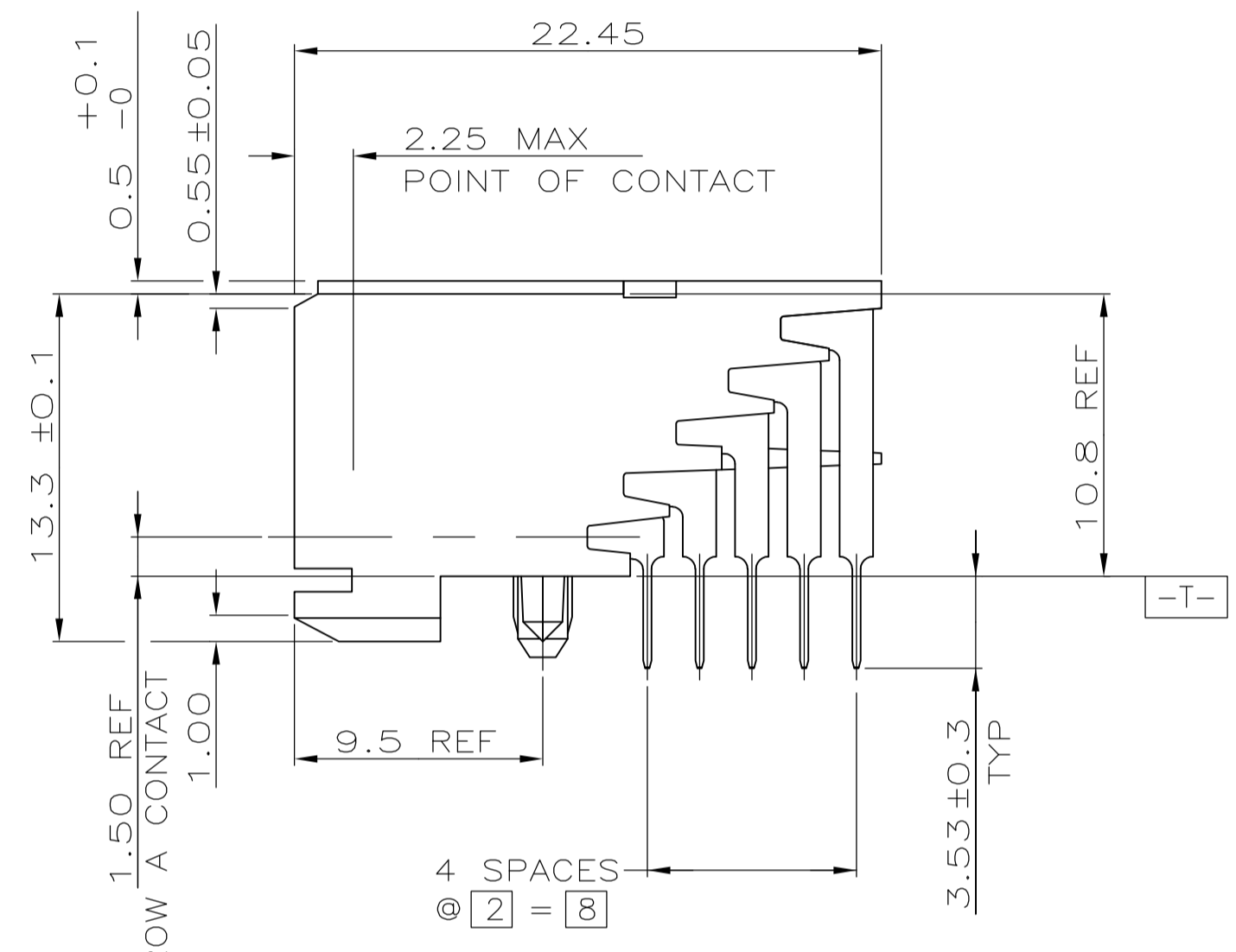
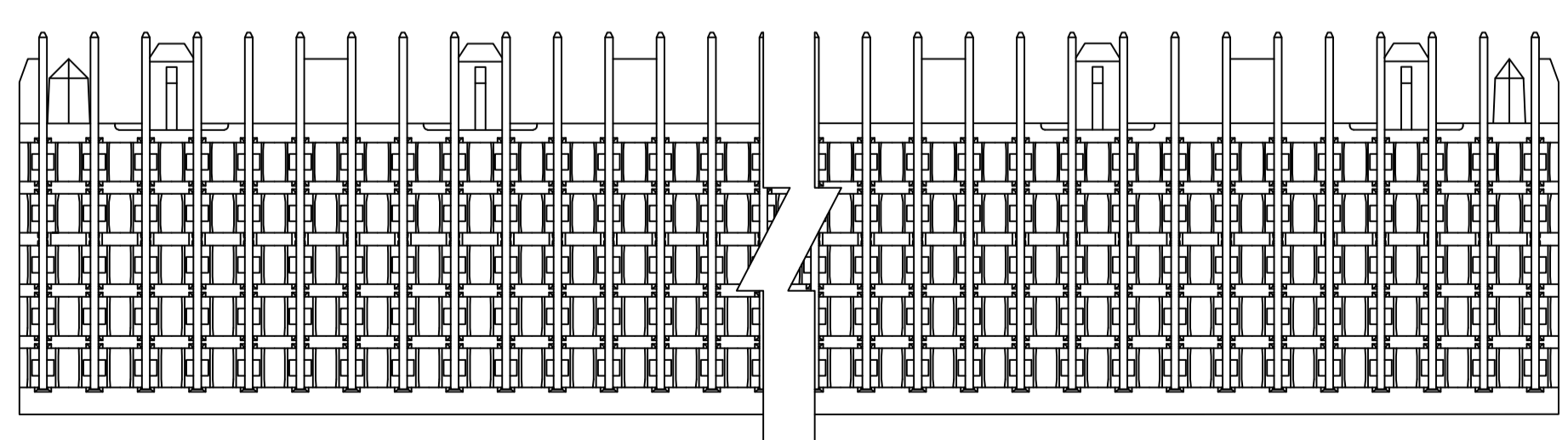
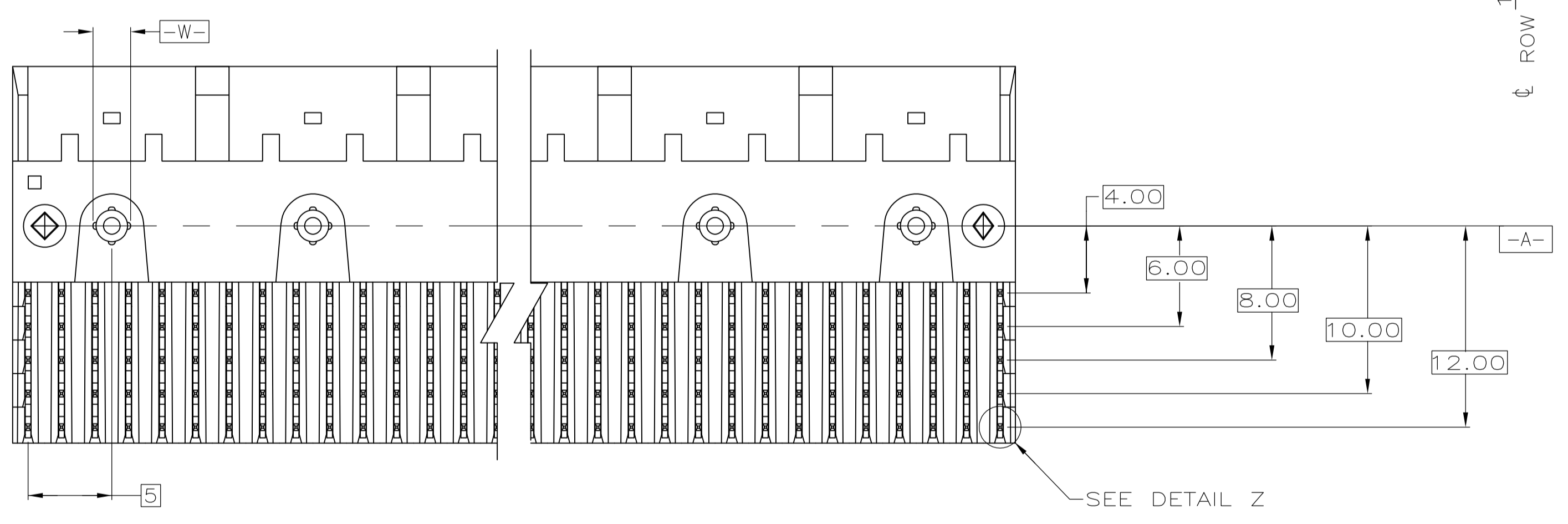
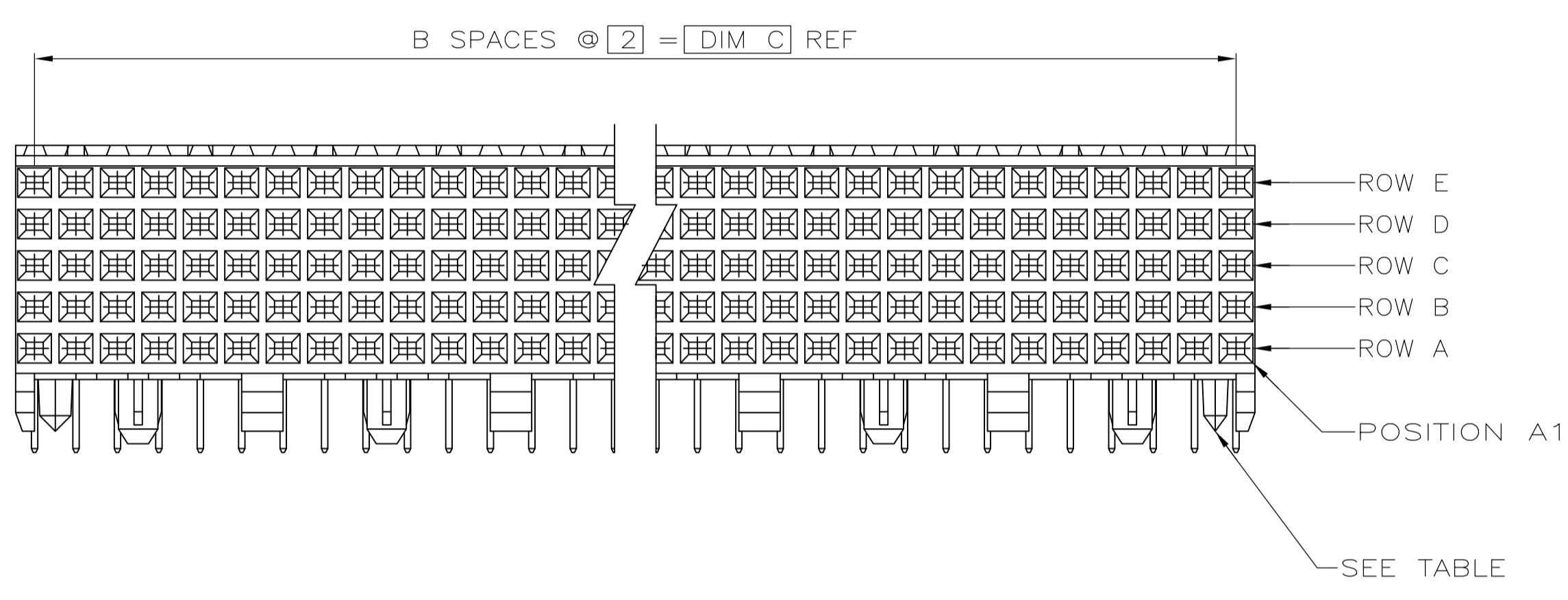
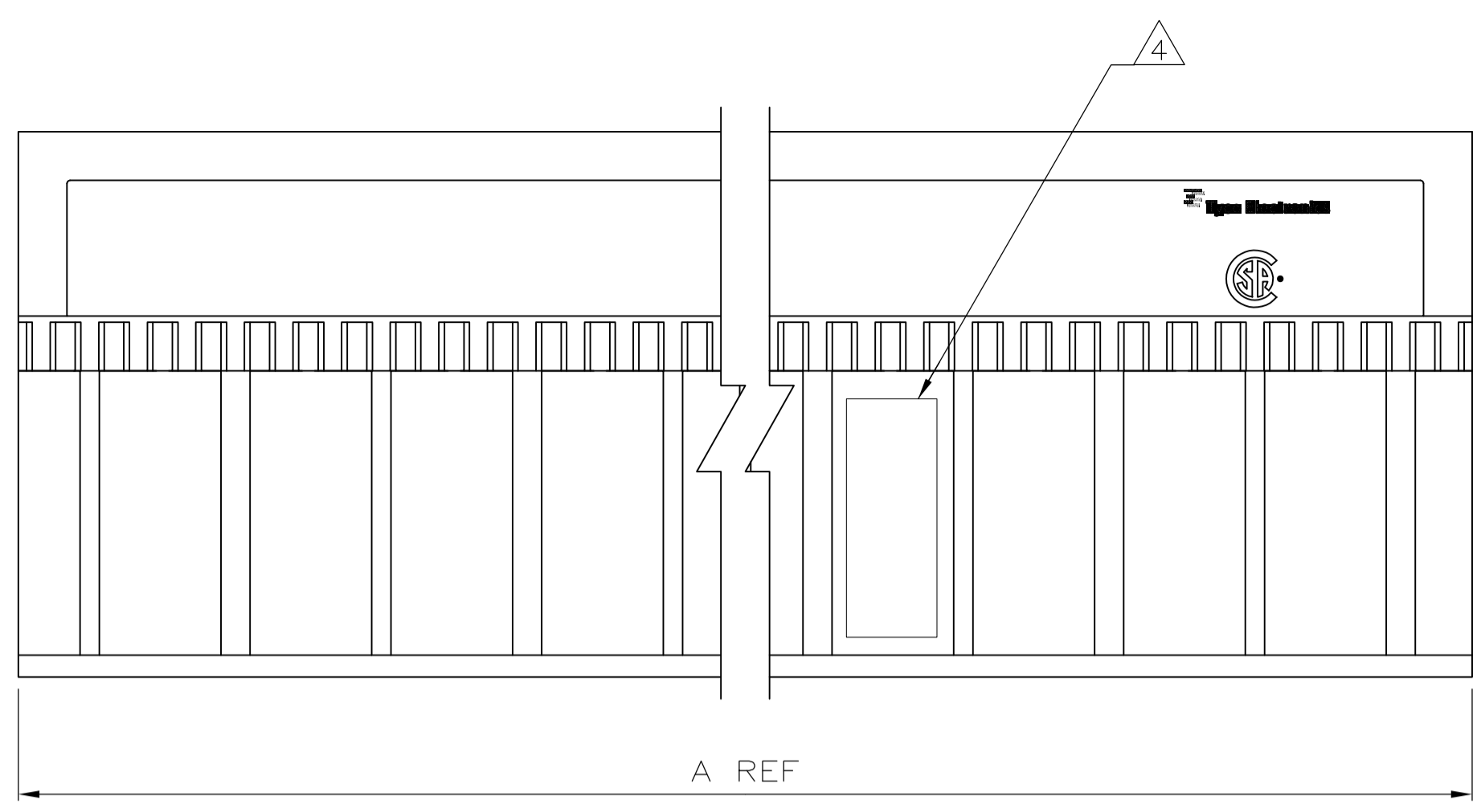

RECOMMENDED CIRCUIT PATTERN
 PER IPC-D300 TYPE II, CLASS C
 (COMPONENT SIDE)

- △ HOUSING MATERIAL: LIQUID CRYSTAL POLYMER
COLOR: NATURAL.
- △ CONTACT MATERIAL: PHOSPHOR-BRONZE.
- △ CONTACT FINISH:(A)
UNDERPLATE (ENTIRE CONTACT):
0.00127 MIN NICKEL PER SAE-AMS-QQ-N-290
ON MATING SURFACES:
CONFORMS TO ALL TESTING SPECIFIED FOR TELCORDIA
UNCONTROLLED ENVIRONMENT.
ON LEADS:
0.00381 MIN MATTE TIN PER ASTM B 545 OVER UNDERPLATE.
LUBRICATION (MIN MATING SURFACES):
SURFACE CONDITIONER AFTER PLATING.
- △ PART MARKING LOCATED APPROXIMATELY AS SHOWN.
- △ OBSOLETE PARTS: OBSOLETE CIS STREAMLINING PER D.RENAUD/D.SINISI

REV	DESCRIPTION	DATE	DMN	APVD	REV	DESCRIPTION	DATE	DMN	APVD
5	OBSOLETE	NO	130	65	131.88	330	1	5223007	1
		NO	118	59	119.88	300	1	5223007	0
		NO	106	53	107.88	270	1	5223007	9
		NO	94	47	95.88	240	1	5223007	8
		NO	82	41	83.88	210	1	5223007	7
		NO	70	35	71.88	180	1	5223007	6
		NO	58	29	59.88	150	1	5223007	5
		NO	46	23	47.88	120	1	5223007	4
		NO	34	17	35.88	90	1	5223007	3
		NO	22	11	23.88	60	1	5223007	2
		YES	10	5	11.88	30	1	5223007	1
	POSITIONING PEGS	C	B	A	NO OF SIGNAL POSN	PART NUMBER			

THIS DRAWING IS A CONTROLLED DOCUMENT.

DIMENSIONS: mm
 TOLERANCES UNLESS OTHERWISE SPECIFIED:
 0. PLC ±
 1. PLC ±
 2. PLC ± 0.13
 3. PLC ±
 4. PLC ±
 ANGLES ±

MATERIAL: △ △ △
 FINISH: △ △ △

THIS DRAWING IS A CONTROLLED DOCUMENT.
 DIB: B. MCMASTER 19NOV04
 CHK: R. WERTZ 19NOV04
 APVD: R. WERTZ 19NOV04
 NAME: R. WERTZ
 PRODUCT SPEC: ASSEMBLY, RECEPTACLE, SIGNAL, RIGHT ANGLE, Z-PACK 2mm FB, 5 ROW, SOLDER LEAD
 APPLICATION SPEC: --
 SIZE: A1
 CAGE CODE: 00779
 DRAWING NO: C=5223007
 WEIGHT: --
 CUSTOMER DRAWING: --
 SCALE: 4:1
 SHEET: 1 OF 1
 REV: A2